

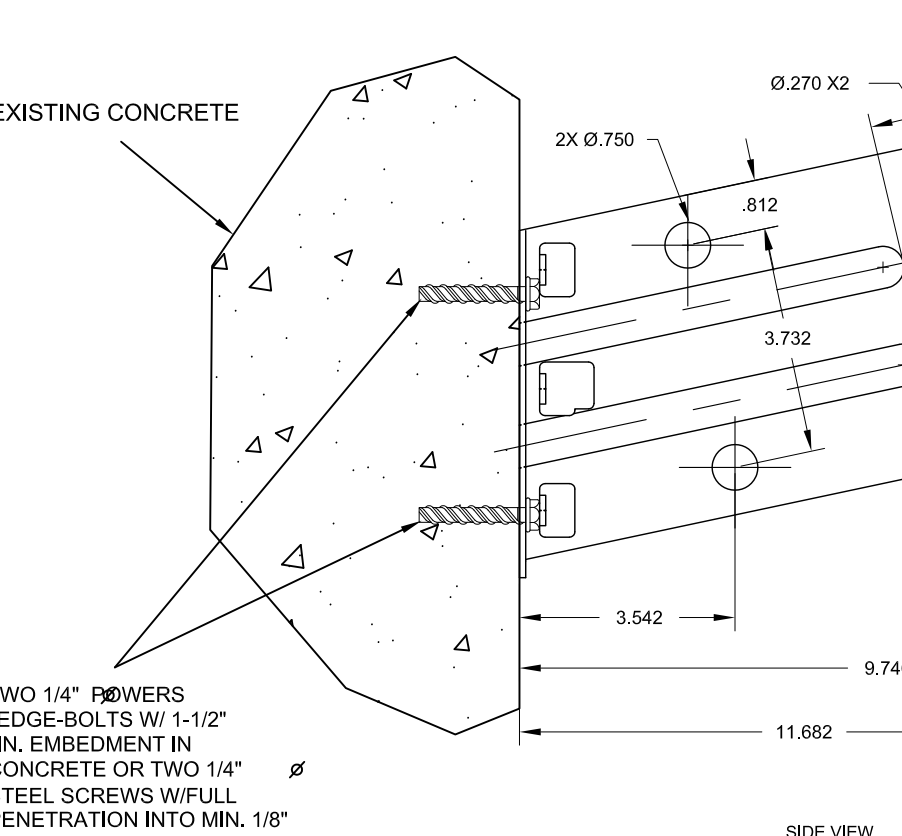

SELF-DRILLING  
PANCAKE HEAD SCREW  
#12-14 X 1" LONG  
@ 12" MAX. O.C.

TAPCON XL  
5/16" X 2-1/4"  
@ 12" MAX. O.C.

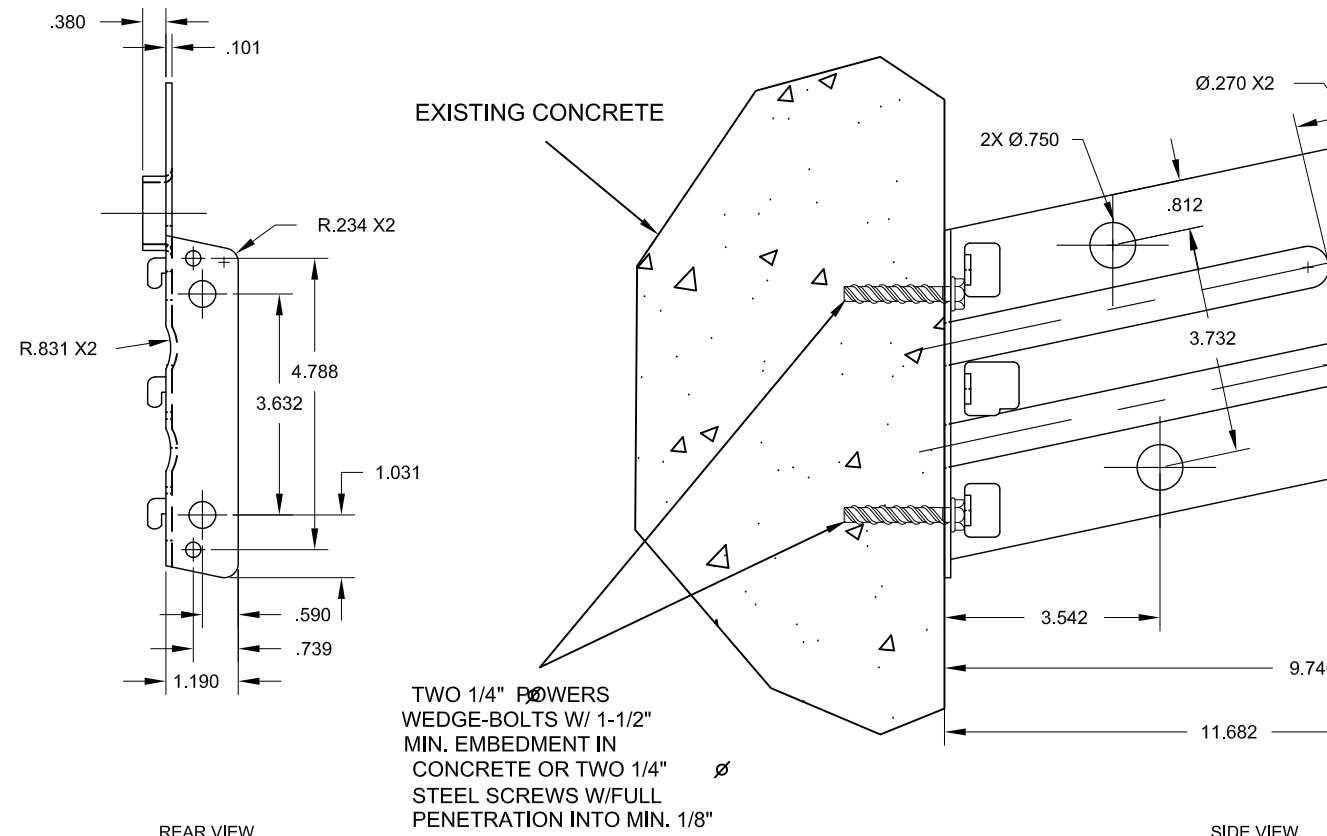
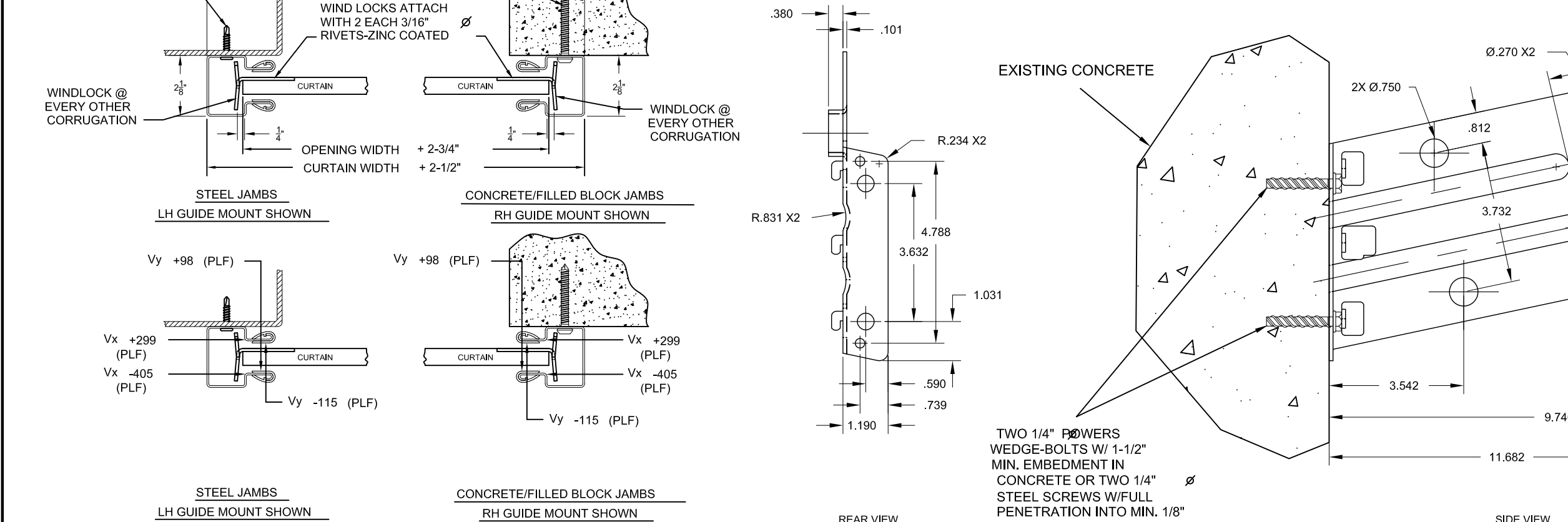

### SUPERIMPOSED LOAD DIAGRAM

### DOOR MOUNTING BRACKET DETAIL

## GENERAL NOTES

1. THIS ROLL-UP DOOR SYSTEM IS DESIGNED IN ACCORDANCE WITH THE FLORIDA BUILDING CODE.
2. THIS ROLL-UP DOOR HAS BEEN TESTED IN ACCORDANCE WITH ASTM E-330 AND COMPLIES WITH ANSI/DASMA 108.

DESIGN LOAD =  $\begin{matrix} +19.4 \\ -22.7 \end{matrix}$  PSF

3. WIND LOADS FOR BUILDING OPENINGS SHALL BE DETERMINED BY A PROFESSIONAL ENGINEER USING APPROPRIATE WIND SPEED AND DESIGN CRITERIA. THIS DOOR MAY BE USED WHERE THE DESIGN LOAD MEETS OR EXCEEDS THE DESIGN LOAD FOR THE BUILDING OPENING.
4. SUPERIMPOSED LOADS ON THE JAMBS FROM THIS DOOR ARE DESIGNED AS  $V_x$  AND  $V_y$  HEREIN. CONTRACTORS SHALL HAVE BUILDING ENGINEER VERIFY ADEQUACY OF BUILDING STRUCTURE TO RESIST SUPERIMPOSED LOADS  $V_x$ ,  $V_y$  AND BRACKET LOADS SHOWN.
5. ALL WELDING SHALL BE PERFORMED BY QUALIFIED WELDERS IN ACCORDANCE WITH A.W.S. SPECIFICATIONS, LATEST EDITION. ALL WELDING ELECTRODES SHALL CONFORM TO A.W.S. A5.1 GRADE E-70.
6. DOORS SHALL BE PROVIDED WITH LOCK MECHANISMS AT THE OPTION OF THE OWNER.
7. ALL BOLTS AND WASHERS SHALL BE GALVANIZED OR STAINLESS STEEL WITH A MINIMUM TENSILE STRENGTH OF 60 KSI.

- 8 DESIGN BASED ON CERTIFIED TESTING LABORATORIES, INC., TEST REPORT  
NO. CTLA - 983W-3
- 9 ANCHOR NOTES:
- A. EMBEDMENT LENGTH DOES NOT INCLUDE STUCCO FINISH.
  - B. FOR HOLLOW MASONRY, FILL ALL CELLS @ ANCHOR WITH 2500 PSI GROUT.
  - C. ANCHORS SHALL BE INSTALLED IN ACCORDANCE WITH MANUFACTURER'S SPECIFICATIONS.
10. DOOR OPERATION TYPE TO BE PUSH-UP.

11. GUIDE TO JAMB ATTACHMENT FASTENERS BEGIN 4" FROM FLOOR AND END 3-1/2" BELOW TOP OF WALL OPENING.
12. TEST DOOR WALL OPENING SIZE: 10'-0" x 8'-0".

THESE CONFIDENTIAL DOCUMENTS SUBMITTED BY JANUS CONTAIN INFORMATION OF A PROPRIETARY NATURE AND MAY NOT BE REPRODUCED OR USED TO MANUFACTURE ANYTHING IN PART OR IN WHOLE FOR ANY PURPOSE OTHER THAN THAT WHICH IS NECESSARY FOR PREPARATION OF BIDS OF ENGINEERING WITHOUT THE EXPRESS PERMISSION OF JANUS WHICH MAY RECALL DOCUMENTS AT ANY TIME.	PART NUMBER:		<b>JANUS INTERNATIONAL CORPORATION</b> 134 JANUS INTERNATIONAL BLVD    TEMPLE, GA    30179 770-562-2850/Fax 770-562-2264 © 2012 Janus International Corporation All Rights Reserved			
	MATERIAL:					
	APPLIED FINISH:		CERTIFIED WIND LOAD RATED 26 GA SERIES 750 DOOR ASSEMBLY MAX. SIZE 10'-0" X 12'-0"			
	UNIT OF MEASURE:					
	APPROVALS					
UNLESS OTHERWISE SPECIFIED DIMENSIONS ARE IN INCHES AND TOLERANCES ARE:  DECIMAL    FRACTIONS    ANGLES    HOLE DIAMETERS  .XX    +.03						